

WARM ROOF – LOADED SYSTEM, COMBINED STRUCTURE, WITHOUT MOISTURE STOP,  
CONCRETE SUPPORTING STRUCTURE, BITUMEN SHEET WATERPROOFING

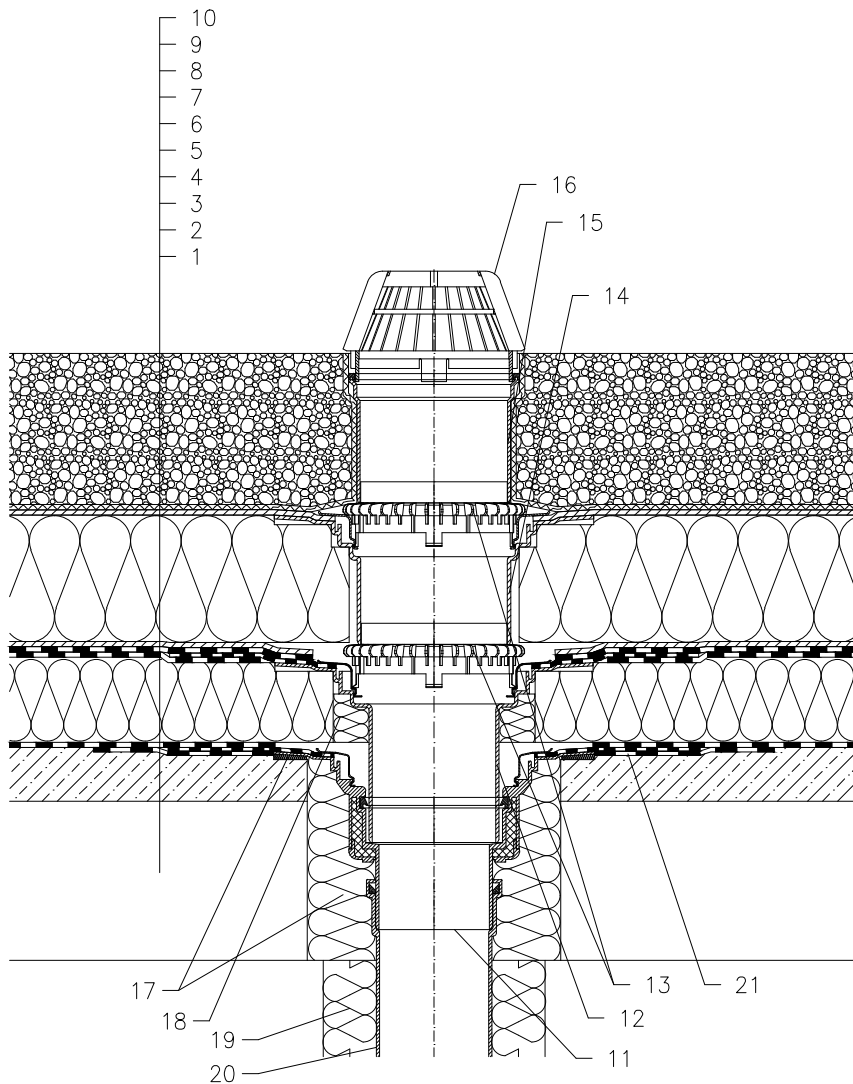

- 1 SUPPORT CONSTRUCTION
- 2 GRAVITY LAYER
- 3 DILATATION LAYER AND TEMPORARY SAFETY WATERPROOFING FROM BITUMEN SHEET
- 4 THERMAL INSULATION
- 5 BITUMEN SHEET WATERPROOFING NON-SOLID GLUED OR LAID LOOSE
- 6 DRAINAGE LAYER
- 7 THERMAL INSULATION FROM XPS
- 8 DRAINAGE LAYER
- 9 FILTER LAYER
- 10 STABILIZING LAYER
- 11 FLAT-ROOF DRAIN HL62H WITH INSULATED DRAIN BODY, WITH FACTORY WELDED BITUMEN MEMBRANE  $\varnothing$ 500 mm, THICKNESS 4 mm
- 12 EXTENSION HL65H WITH FLANGE AND FACTORY WELDED BITUMEN MEMBRANE  $\varnothing$ 500 mm, THICKNESS 4 mm
- 13 GRAVEL GUARD HL160
- 14 EXTENSION HL350.0 WITH FLANGE AND WATERPROOFING KIT HL84.0
- 15 EXTENSION HL350
- 16 DOMED PLASTIC GRATE  $\varnothing$ 180 mm (INCL. WITH HL62H)
- 17 ASSEMBLY FOAM
- 18 FILL FREE SPACE WITH MINERAL WOOL
- 19 DOWNPIPE THERMAL INSULATION
- 20 DOWNPIPE
- 21 BITUMEN MEMBRANE,  $\varnothing$ 750 mm

NOTE:

FLAT-ROOF DRAIN HL62.1H HEATED (230V, 10-30 WATTS) CAN BE USED.

ASSEMBLY INLET:  $\varnothing$ 255 MM, ALTERNATIVELY 255X380 MM

14111A