

WARM ROOF – GREEN ROOF, COMBINED STRUCTURE, PLASTIC FOIL WATERPROOFING  
EXTENSIVE GRASSING

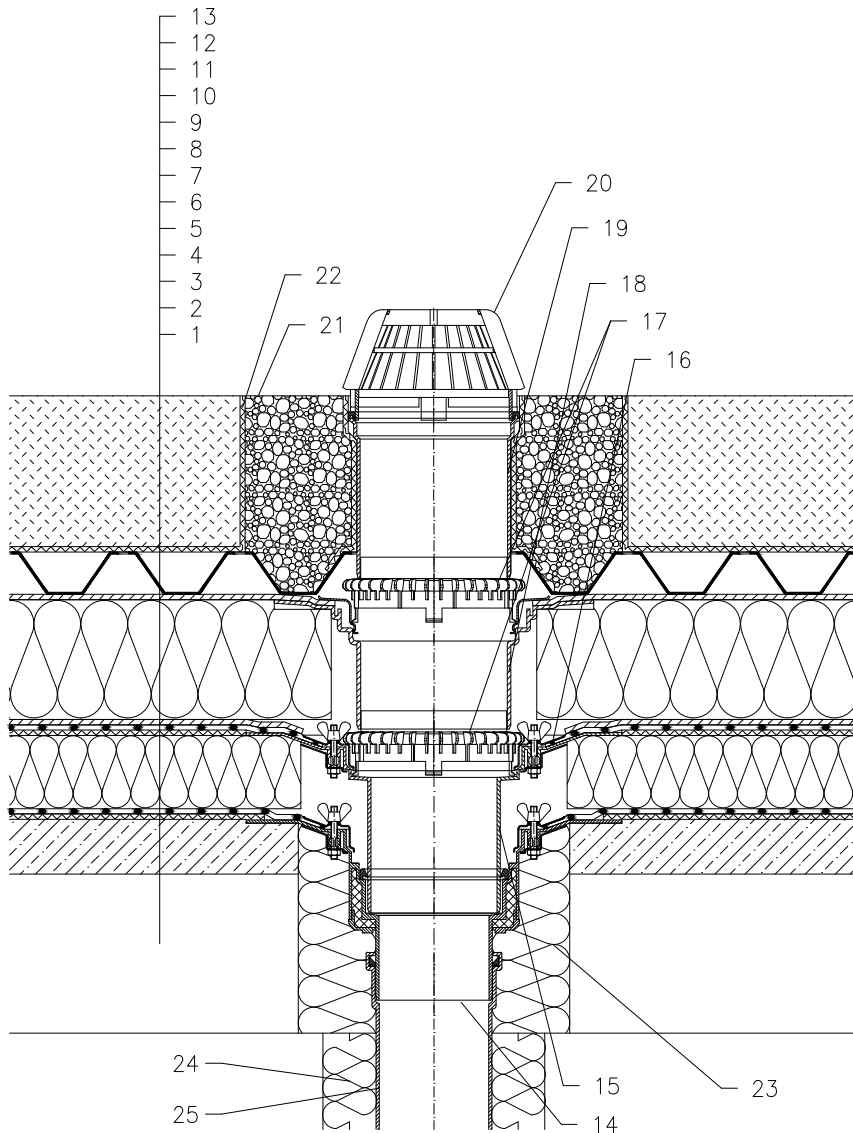

- 1 SUPPORT CONSTRUCTION
- 2 GRAVITY LAYER
- 3 DILATATION LAYER
- 4 MOISTURE STOP AND TEMPORARY SAFETY WATERPROOFING FROM PLASTIC FOIL
- 5 THERMAL INSULATION
- 6 DILATATION LAYER
- 7 PLASTIC FOIL WATERPROOFING LAID LOOSE
- 8 DRAINAGE LAYER
- 9 THERMAL INSULATION FROM XPS
- 10 DRAINAGE LAYER
- 11 WATER ACCUMULATING LAYER
- 12 FILTER LAYER
- 13 VEGETATION LAYER (UNDER 200 mm)
- 14 FLAT-ROOF DRAIN HL62 WITH INSULATED DRAIN BODY, FLANGE AND STAINLESS STEEL CLAMPING RING, (FOR PVC SHEETINGS FLAT-ROOF DRAIN HL62P; FOR FPO SHEETINGS BASED ON PP FLAT-ROOF DRAIN HL62F)
- 15 EXTENSION HL65 WITH FLANGE, STAINLESS STEEL CLAMPING RING AND LIP SEAL, (FOR PVC SHEETINGS FLAT - EXTENSION HL65P; FOR FPO SHEETINGS BASED ON PP FLAT - EXTENSION HL65F)
- 16 SEALING PACKING (SEE DETAIL-ACCESSORIES)
- 17 GRAVEL GUARD HL160
- 18 EXTENSION HL350.0 WITH FLANGE AND WATERPROOFING KIT HL84.0
- 19 EXTENSION HL350
- 20 DOMED PLASTIC GRATE  $\varnothing$ 180 mm (INCL. WITH HL62)
- 21 GRANULAR FILL
- 22 DILATATION LAYER
- 23 ASSEMBLY FOAM
- 24 DOWNPIPE THERMAL INSULATION
- 25 DOWNPIPE

NOTE:

FLAT-ROOF DRAIN HL62.1  
SHEETINGS FLAT-ROOF DRAIN HL62.1P; FOR FPO  
SHEETINGS BASED ON PP FLAT-ROOF DRAIN HL62.1F)  
HEATED (230V, 10-30 WATTS) CAN BE USED.

ASSEMBLY INLET:  $\varnothing$ 255 MM, ALTERNATIVELY 255X380 MM

142312