

WARM ROOF – WALKABLE, COMBINED STRUCTURE, BITUMEN SHEET WATERPROOFING  
PAVEMENT ON STANDS

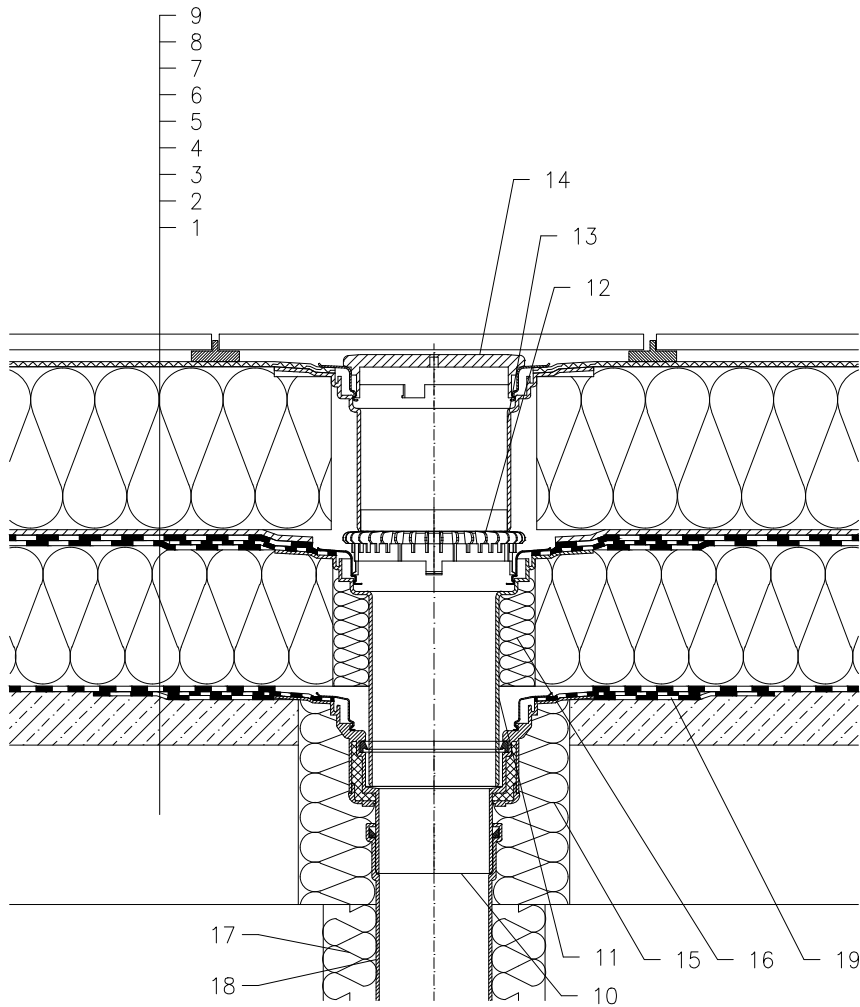

- 1 SUPPORT CONSTRUCTION
- 2 GRAVITY LAYER
- 3 MOISTURE STOP AND TEMPORARY SAFETY WATERPROOFING FROM BITUMEN SHEET
- 4 THERMAL INSULATION
- 5 BITUMEN SHEET WATERPROOFING NON-SOLID GLUED OR LAID LOOSE
- 6 DRAINAGE LAYER
- 7 THERMAL INSULATION FROM XPS
- 8 DILATATION LAYER
- 9 PAVEMENT ON STANDS
- 10 FLAT-ROOF DRAIN HL62H WITH INSULATED DRAIN BODY, WITH FACTORY WELDED BITUMEN MEMBRANE  $\varnothing$ 500 mm, THICKNESS 4 mm
- 11 EXTENSION HL65H WITH FLANGE AND FACTORY WELDED BITUMEN MEMBRANE  $\varnothing$ 500 mm, THICKNESS 4 mm
- 12 GRAVEL GUARD HL160
- 13 EXTENSION HL350.0 WITH FLANGE AND WATERPROOFING KIT HL84.0
- 14 FLAT GRATE HL170
- 15 ASSEMBLY FOAM
- 16 FILL FREE SPACE WITH MINERAL WOOL
- 17 DOWNPIPE THERMAL INSULATION
- 18 DOWNPIPE
- 19 BITUMEN MEMBRANE,  $\varnothing$ 750 mm

NOTE:

FLAT-ROOF DRAIN HL62.1H HEATED (230V, 10-30 WATTS) CAN BE USED.

ASSEMBLY INLET:  $\varnothing$ 255 MM, ALTERNATIVELY 255X380 MM

142131A